

Patent No. 568456

Precision™

AM60

MAGNETIC TUBULAR LATCH



Also available

Precision™

AM60PV

TUBULAR PRIVACY BOLT

Backset-60mm
Finish-Brushed S/Steel
Suits 5mm and 6x2mm splindles

- No protruding latch when door is in the open position-nothing to catch clothing etc on
- No visible strikeplate lip when the door is closed.
- Suitable for all types of 'sprung' door handles
- Strong metal latchbolt
- Quieter closing-unlike conventional latches, the latch doesn't actually 'strike' the lip of the strikeplate when closing the door. Upon closing the door, a powerful magnet embedded in latchbolt becomes attracted to a magnet fitted inside the strikeplate assembly, causing the latch quickly enter the strike plate thus keeping the door closed.
- Backset- 60mm
- Bolt through fixing
- Suits 8mm and 7.56mm spindles
- Manufacturers guarantee- 10 years

• Patented new latch face and strikeplate design/installation procedure

Much easier and faster to install than traditional 'rectangular face' latches/strikeplates due an **innovative and patented design/installation process** that uses mainly drilling (with a 24-25mm spade bit) and only a minimal amount of chiseling to create the recesses required to flush mount the latch/strikeplate. **FIG A**

• Patented S/Steel housing cups

The housing cup's flanged lip covers unsightly installation recesses and mounts faceplate and strikeplate perfectly flush to the surface (regardless of recess depth) for a professional finish.

- **Strikebox/drilling guide**- innovative dual purpose design allows this component to firstly be used as a drilling template for creating the recesses in door and jamb required to fit the latch and strikeplate, then is fitted behind the strikeplate to act as a dust box providing a more attractive finish. (the **strikebox/drilling** guide component also contains a concealed magnet-to attract the 'latch magnet').

- **Strikeplate**- unique 'double adjustment tab' design offers a greater range of latch adjustment possibilities (+/- 1.5mm) **FIG B**

- **S/Steel coverplates (self adhesive)** conceal the screwheads, providing a sleek minimalist finish) Adhesive: 3M9448A - provides very high bonding strength and excellent durability.

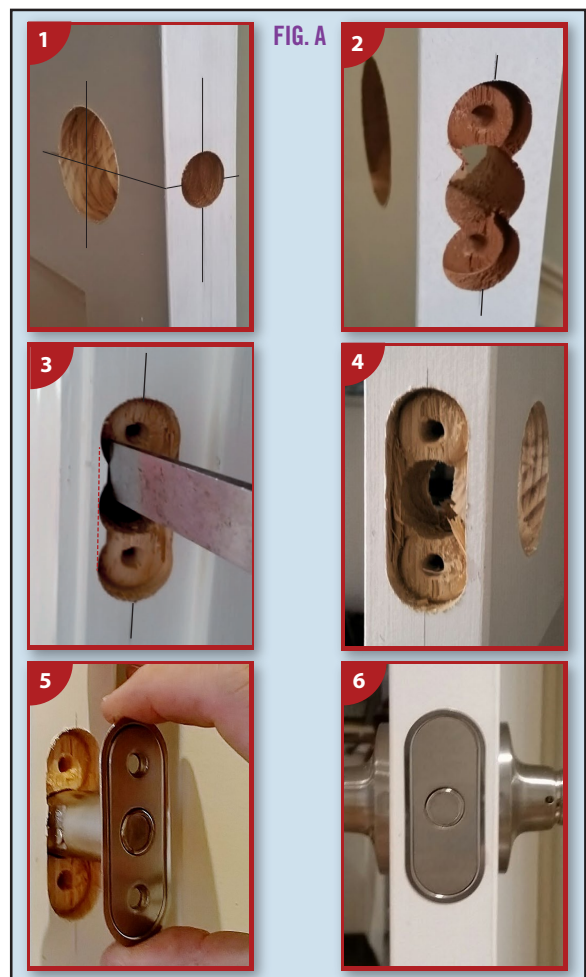

- **AM60 ITP installation tool pack (sold separately)** Use the 'Strikemarker' tool to easily and accurately mark a position on the jamb to mount the strikeplate. Use the screwdriver included to 'bend out' the strike plate's adjustment tabs as required, to reduce 'latch rattle'.

