

Install Instructions

Privacy Turn

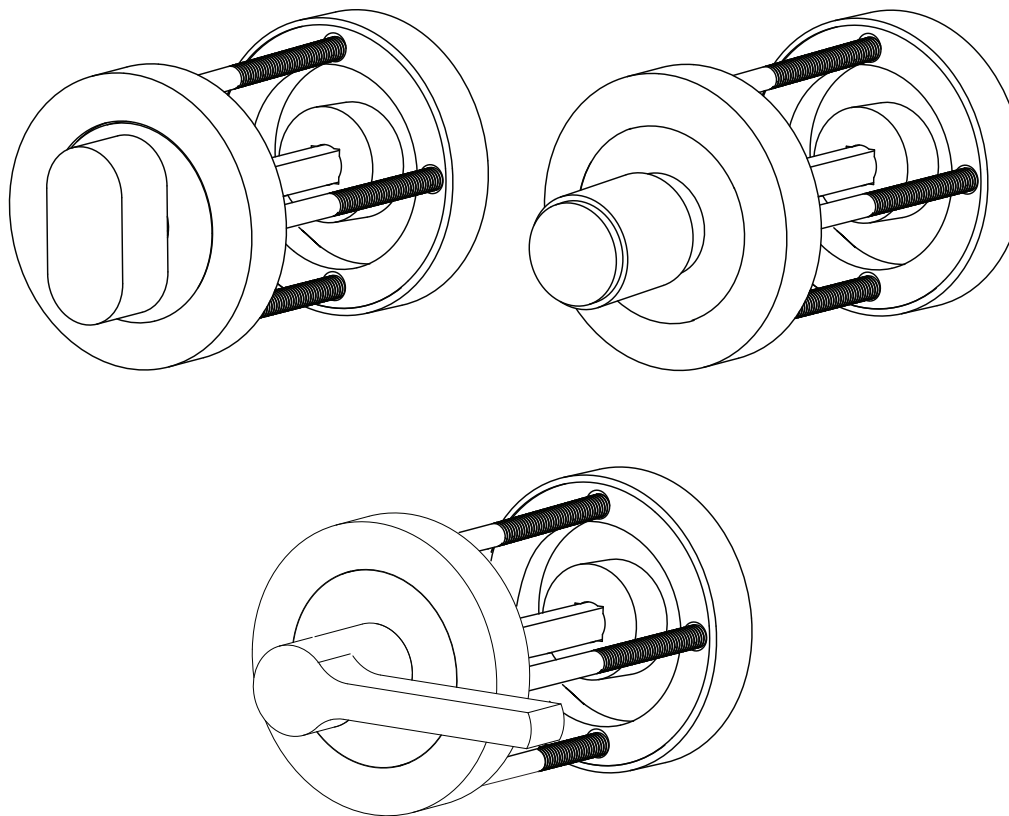

Scan for
Warranty



Scan for
Drill Template



Scan for
Product &
Finish Care
Information



*Image used for illustration purposes only.

Contact Us Southern Design Group

Australia
14 - 16 Stepney Street,
Stepney, South Australia 5069
P: +61 (0)8 8362 1133
info@iver.com.au
iver-life.com/au

New Zealand
P: +64 (0)6 359 0008
info@iver.co.nz
iver-life.com/nz

SDG Trading Pty Ltd
trading as Iver
ACN 008 154 041 | ABN 18 008 154 041



1. Unscrew the outer rose (C) from inner rose privacy turn (B) & inner rose emergency release (A). Figure 1.

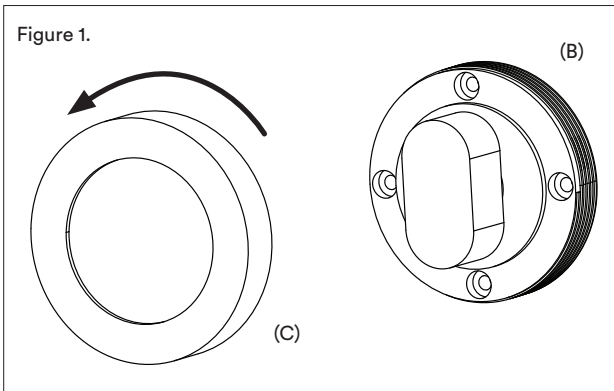

2. Install privacy mechanism (purchased separately). Refer to supplier instructions.

*Template available online if required.



3. Drill the pilot holes from both sides of the door.
4. Drill the privacy hole using a 12.5mm or 1/2" spade bit from both sides of the door.
5. If using the wood screws (G) proceed to step 8.
6. If using connector bolts (F), shorten as required to suit the door thickness. Figure 2.

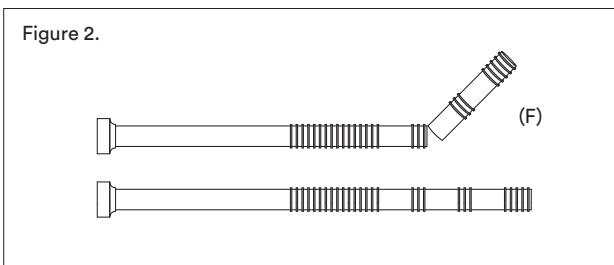

7. Ensure to cut so the connector bolt (F) does not protrude from the opposite inner rose once installed. Figure 3.

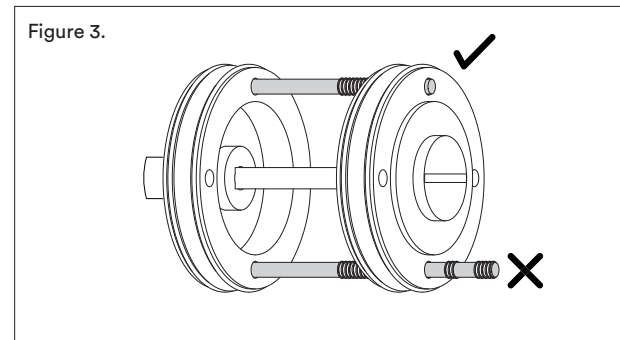

8. For standard privacy turn place the spindle (D) through your privacy mechanism. Adjust the spindle (D) length to suit your door thickness.
9. For the accessibility privacy turn place the rounded end of the accessibility spindle (E) into the inner rose privacy turn (B) and push the split pin through the hole and bend the end of the split pin over so it cannot be removed. Figure 4. Adjust the accessibility spindle (E) length to suit your door thickness. Figure 5.

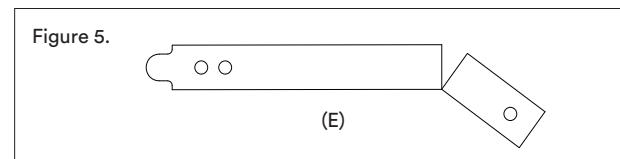
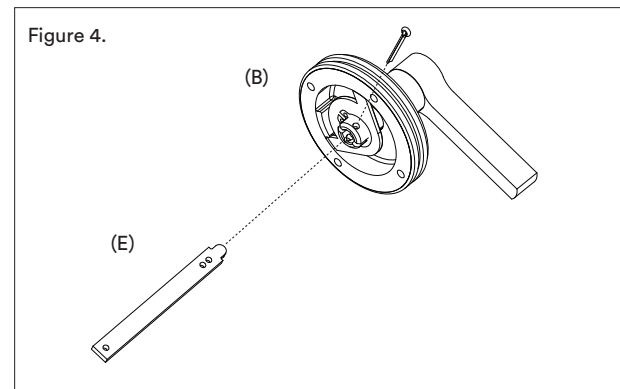

10. Place the inner rose privacy turn (B) over the spindle (D) from the inside of the door. *For an accessibility turn, place privacy turn (B), with turn in the horizontal position, with flat spindle (E) through your privacy mechanism.
11. Place the inner rose emergency release (A) over the spindle on the outside of the door with the slot facing vertical.
12. If using connector bolts (F) insert two of the connector bolts through the inner rose privacy turn (B) at 3 o'clock and 9 o'clock, screwing them into opposite side inner rose emergency release (A). Repeat at 12 o'clock and 6 o'clock. Figure 6.

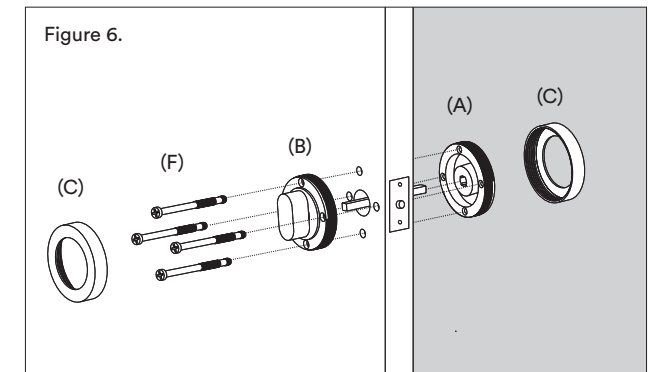

13. If using wood screws (G) attach both inner roses at all fixing points. Figure 7.

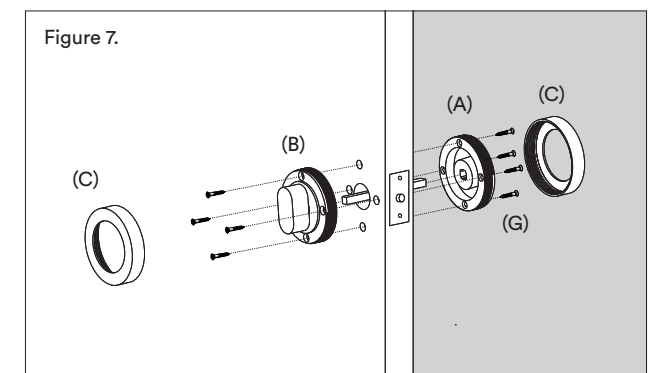

14. Screw on the outer roses (C) over inner roses (A & B).

INCLUDED

Inner rose emergency release x 1 (A)

Inner rose privacy turn x 1 (B)

Outer rose x 2 (C)

Privacy spindle L75mm x 1 (D)

^Accessibility spindle flat & split pin x 1 (E)

Connector bolts L65mm x 4 (F)

Wood screws L25mm x 9 (G)

*Allen key x 1 (H)

*Grub screw x 2 (I)

^ This is the only spindle supplied with accessibility turns.

* Supplied with square rose only.

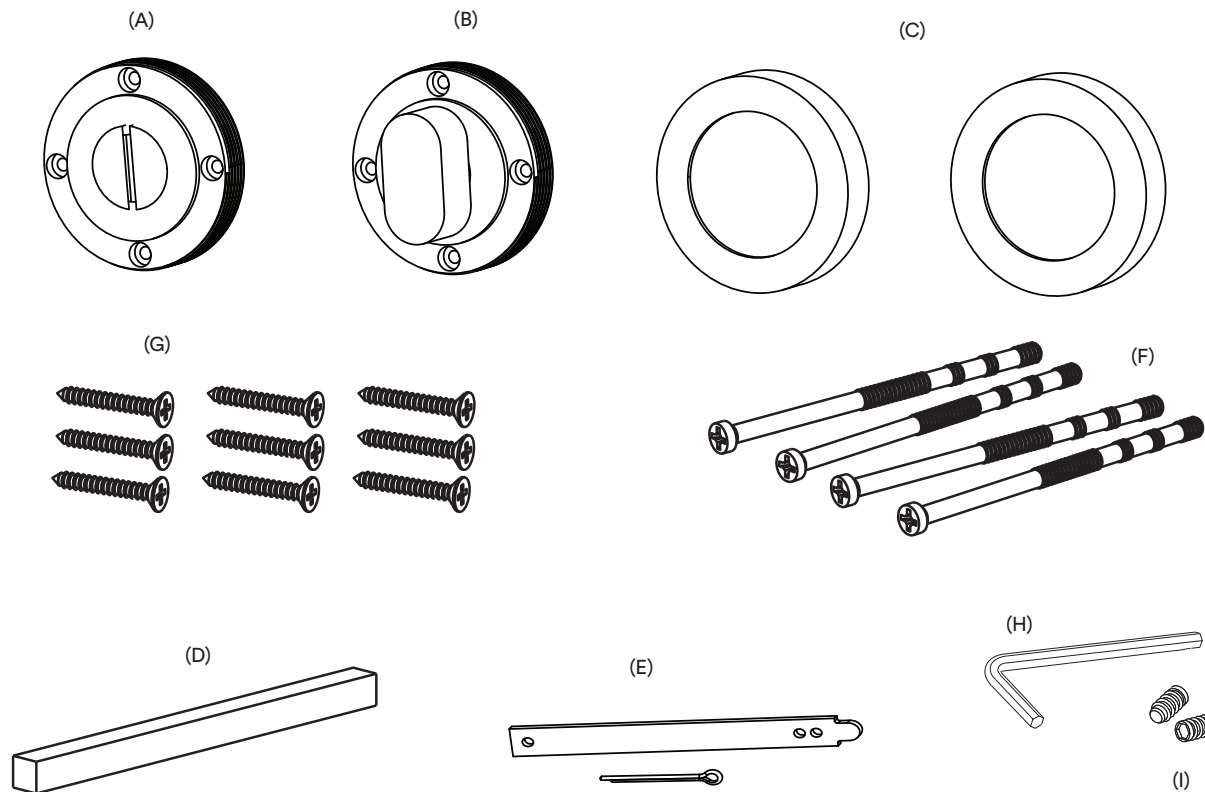

IMPORTANT

Please install this hardware in the following order to ensure its warranty is not voided.

1. Install the hardware on raw / unfinished door using the instructions provided.
2. Remove hardware (where possible) and store safely. Do not place tape onto the hardware as this will damage the finish.
3. Paint / finish door.
4. Reinstall hardware.

PLEASE NOTE:

Please note that screws require **pre-drilling**. Please take extra care when fitting.

