



67 Series

Door furniture



Fire Rated: Tested on fire door assemblies in accordance with Australian Standards, refer fire door manufacturer for specific approval details

The Legge commercial range of door furniture has been designed to meet the demands of commercial applications, such as interior and exterior doors for retail, educational, governmental, medical and public buildings.

Legge commercial furniture should be specified where heavy use is experienced and durable door furniture is essential.

Features

- Constructed of quality components, with forged brass levers and roses
- Heavy duty spring provides a smooth, fast return action of the lever and minimises droop extending the life of the furniture
- Furniture re-handed by simple relocation of stop block
- The 10 year warranty provides specifiers and users with assured quality and performance
- Suitable for use on fire door assemblies when used with fire rated locks and latches

Specification guide



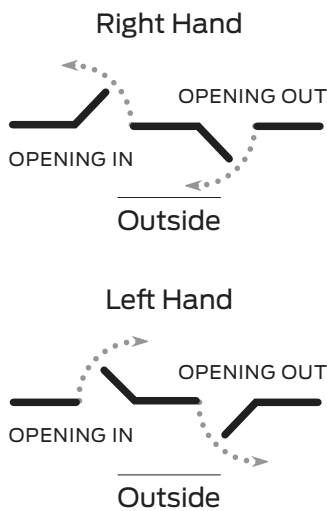

Function	Lever	Finish
Lock/latch furniture 67	refer following pages	Chrome plate CP
External half set 67E		Polished brass PB
Internal half set 67I		Satin chrome plateSCP
External blank rose 67EB		
Internal blank rose 67IB		

- Function
Select the desired function e.g. Lock/latch furniture 67/
- Lever
Select the required lever design e.g. Angelo #57 67/57
- Finish
Select the desired finish e.g. Satin chrome plate 67/57SCP

Handing guide

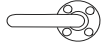
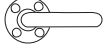

Specifications	
Door type	Timber or metal
Door thickness	32mm to 50mm
Fixing centres	50.8mm
Spindle size	7.6mm
Compatible locks/latches	Legge 990MF Series mortice locks Legge 12002 tubular latch
Fixing	Back to back, external plates concealed fixing, screws supplied with exterior plates only, screw length 75mm
Materials	Forged brass
Finishes	Chrome plate, polished brass, satin chrome plate
Warranty	10 year mechanical

Functions	Outside	Inside
67 - Latch furniture Two levers to be used with a latch or converted to dummy trim with fixing kit		
LR67 - Lock/latch furniture Two levers to be used with a latch		
LR67 - External half set One lever to be used with a latch or converted to dummy trim with fixing kit		
LR67 - Internal half set One lever to be used with a latch or converted to dummy trim with fixing kit		

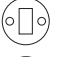
Escutcheons	
22 forged brass or 26 pressed brass with cylinder hole	
23 forged brass or 27 pressed brass with turn	
24 forged brass or 28 pressed brass with emergency release	

Legge 67 Series levers

Alessandro #55 

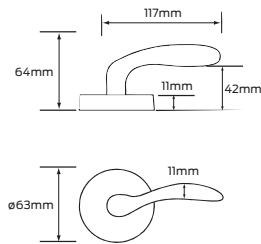

Alpha #29

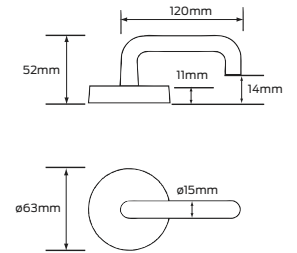

Angelo #57

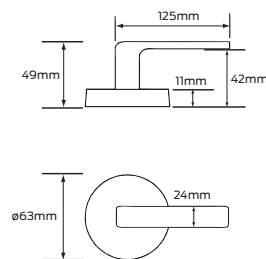

Bergen

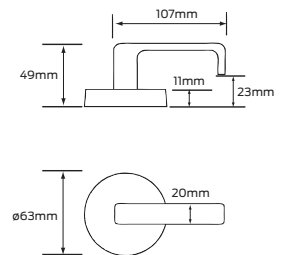

Chagall #51 

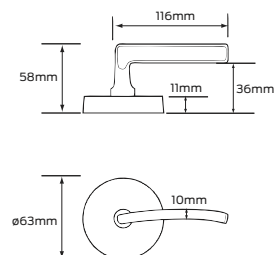

Cisa #59

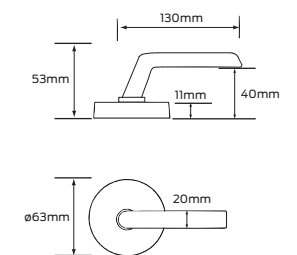

Legge 67 Series levers

Diablo #15

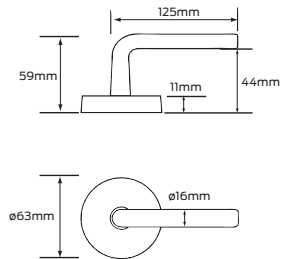

Ergo #62

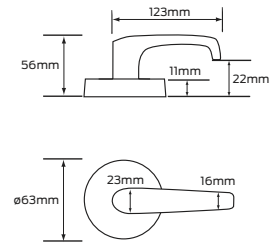

Flaire

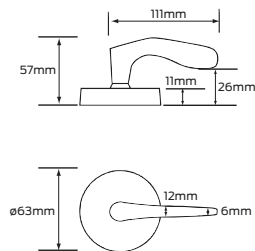

Leonardo #12

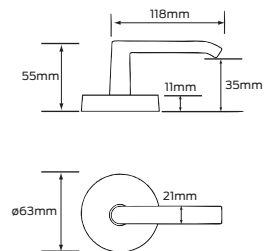

Monet #50

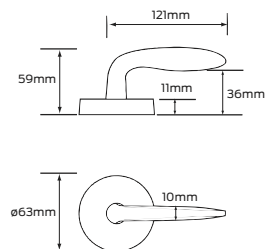

Neptune

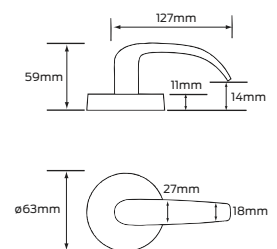

Legge 67 Series levers

Omega

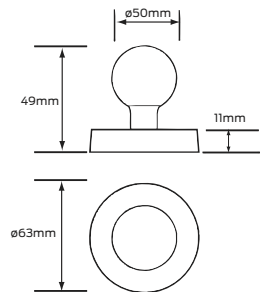

Renoir #52

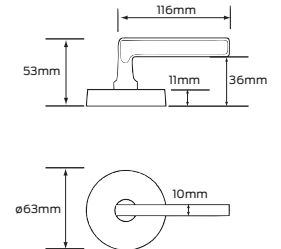

Rubens #56

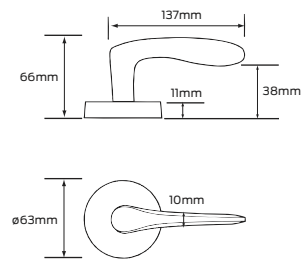

Salvador #27

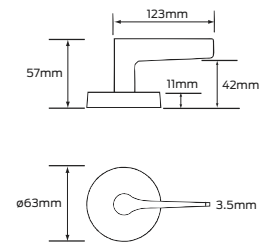

Trilo #61

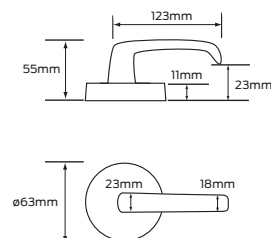

Legge 67 Series escutcheons

Forged brass

Pressed brass

Cylinder #22

Cylinder #26

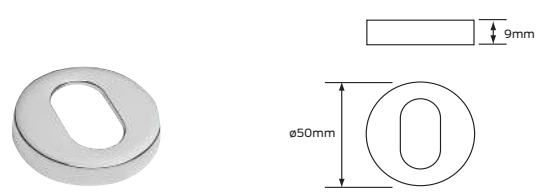
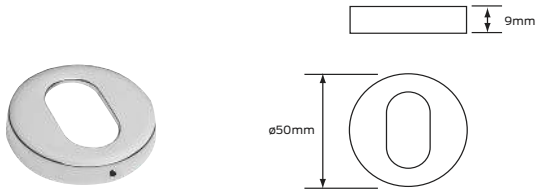

Emergency release #24

Emergency release #28

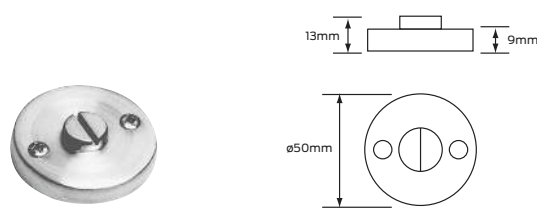
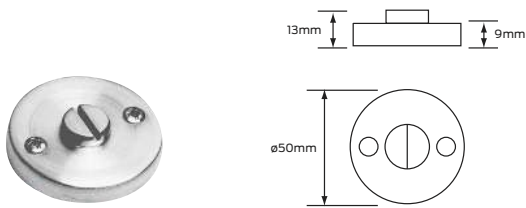

Turn #23

Turn #27

