

# Lumos<sup>®</sup> LED Handrail Bracket

Illuminatingly Intelligent

DESIGNED BY  
MILES NELSON

5 YEAR  
WARRANTY



## LUMOS® the revolutionary new LED illuminated handrail bracket. One fitting, one solution for your stair/walkway lighting and handrail fixing.

Suitable for interior/exterior domestic and commercial use. Recommend one bracket per 900mm spacing. Transformers supplied separately. Each transformer can power a maximum of 16 lights. Use only a Miles Nelson regulated power transformer. Failure to use a Miles Nelson regulated 12 volt DC will void warranty. Transformer tested to AS/NZS3108 @ 25°C.

### Product features

- Modern styling
- Interior/Exterior
- Concealed fixing
- Easy installation
- Environmentally friendly: Very low power consumption (Approx 60c per annum for one light 24 hours, 365 days, based on 15c a unit of electricity)
- LED Bulb life approx 12 years under continuous use
- Cost savings – 1 fitting for rail and lighting
- Adapter, with locator pins, for flat profile mouldings included
- Matching style also available without light option

### Safety features

- Cold light – no heat to injure young hands
- Low level stair/walkway lighting
- Static load tested to ASTM E 985.00 and exceeds 800kg
- 12 volt regulated DC
- Light coverage area at max. height (1mtr above pitch line) 900mm Dia
- Bracket must be solid mounted
- Complies with BIA acceptable solution D1/AS1
- Potential to use for emergency lighting with appropriate equipment

### Specifications diagram

- Base: 70mm(H) x 50mm(W) x 52mm(D)
- Wall projection: 70mm
- Upstand height: 80mm
- Overall height: 115mm

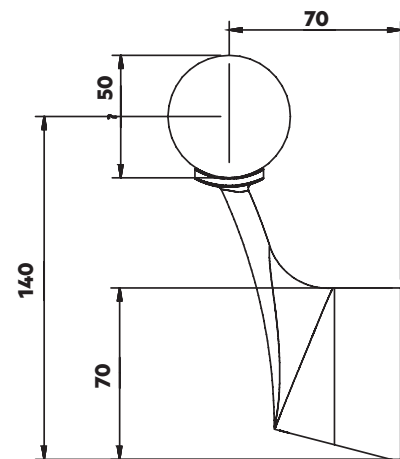

### Lumos® Led Handrail Bracket

|  |          |    |
|--|----------|----|
| Indoor use   | 610SCBP  | SC |
| Powder coated finish for outdoor use                 | 610SCEBP | SC |
| Indoor use (without light)                           | 611SCBP  | SC |
| Powder coated finish for outdoor use (without light) | 611SCEBP | SC |

DESIGNED BY  
MILES NELSON

5 YEAR WARRANTY



### Lumos® Transformer

- 12 volt
- Each transformer can power 16 lights
- Tested to AS/NZS3108 at 25°C

612PA