

Installation Instructions for Trilock Traditional & Contemporary Series – Double & Single Cylinder

These instructions apply to both Lever and Knob versions

Step 1.

- Fold template where indicated.
- Position template on door edge at desired lock / latch height.
- Firmly hold template and mark latch height and 54mm (2 1/8") lock body hole centre.
- Measure door thickness and mark centre on 'latch height' marking.
- Drill 22mm (7/8") latch hole.
- Note:** it is important to drill this hole squarely.
- Drill pilot hole for lock body [suggested size 3mm (1/8")]. Then enlarge holes to 54mm (2 1/8"), drilling from both sides of the door.

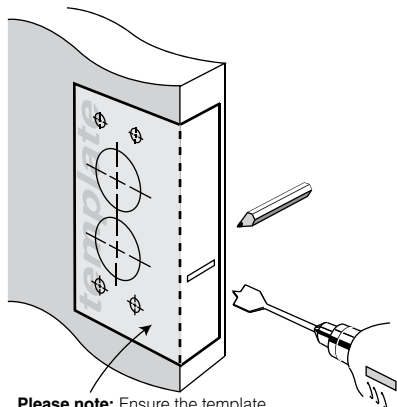

Please note: Ensure the template position and orientation is as shown, incorrect installation voids warranty.

Step 2.

- Mark and chisel latch faceplate to a recess of 3.5mm.
- Use latch carrier as a template.
- Insert lock body into 54mm (2 1/8") hole.
- Insert latch carrier through 22mm (7/8") hole into lock body assembly and tighten with 2 screws.

Ensure T-shaped hole at rear of latch carrier is upright!

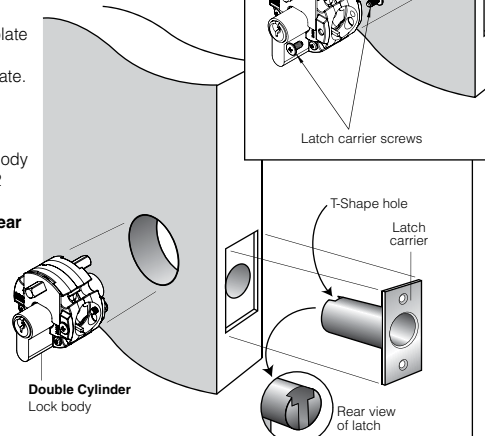

Please note:

For the single cylinder Trilock version, the turnbutton stem should be on the internal side of the door.

If this is not the case, please re-hand the lock body.

To re-hand: remove the grub screw with allen key provided, remove and turn the cylinder to desired direction and re-install. Re-fasten grub screw with allen key.

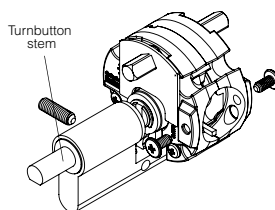

Step 3.

- Insert the latch through the slot in the carrier until it can go no further.
- Insert the key and turn to retract the latch bolt.
- Pre-drill wood screw holes with suitable drill size.
- Install plastic faceplate shim and faceplate, then screw into position.

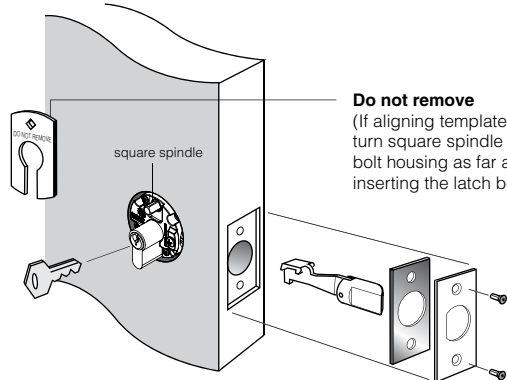

Do not remove

(If aligning template has been removed turn square spindle away from the latch bolt housing as far as it can go before inserting the latch bolt).

Step 3a

Trilock Latch Bolt re-handing.

- Check that tapered side of the latch bolt faces towards the door jamb.
- If not it will be necessary to unclip the rear arm & rotate bolt 180°.
- This is achieved by following steps:

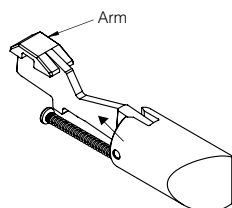

1. Remove latch bolt assembly from carrier

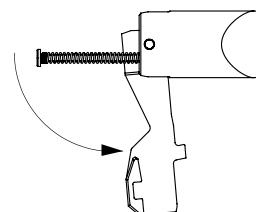

2. Rotate arm downwards

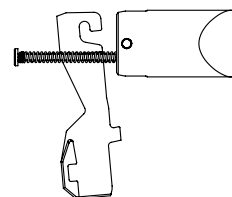

3. Unclip arm from latch bolt

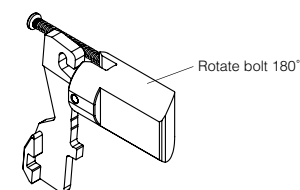

Rotate bolt 180°

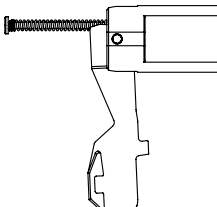

5. Re-attach arm to latch bolt

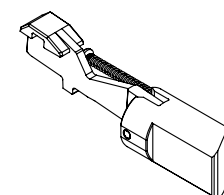

6. Rotate arm upwards & fit back into carrier

Step 4

- Remove perforated cut-out from cardboard template and place over lock body, making sure template is square to door edge.
- While holding template firmly in position, mark remaining 5 holes, as indicated on both sides of the door (reversing template as required).
- Drill pilot holes from both sides of the door [suggested size 3mm (1/8")] then enlarge, again from both sides of the door, to sizes indicated on template, otherwise correct functioning may be impeded – refer template.
- In particular, ensure the 54mm (2 1/8") dia. hole through door face (located above lock body hole) is drilled only to correct size, otherwise correct functioning may be impeded – refer template.

Note: Top 54mm hole must have burrs removed before installing Trilock as this will effect snib rotor operation & privacy function.

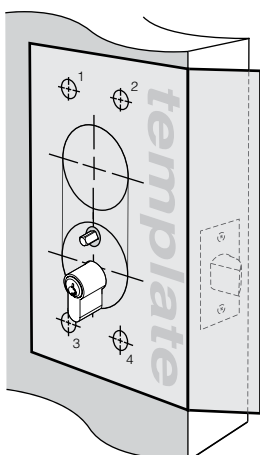

NOTE:

- carefully follow these instructions when installing.
- do not overtighten screws.
- use of power driver is not recommended.
- fully remove the Trilock prior to painting the door to avoid harming the product's finish.

Gainsborough
ENTER WITH STYLE™

3 IN 1 FUNCTION
TRILOCK™
DEADBOLT | LOCKSET | PASSAGE SET

Installation Instructions for Trilock Traditional & Contemporary Series – Double & Single Cylinder

These instructions apply to both Lever and Knob versions

Step 5

To re-hand levers & set lever operation (if required).

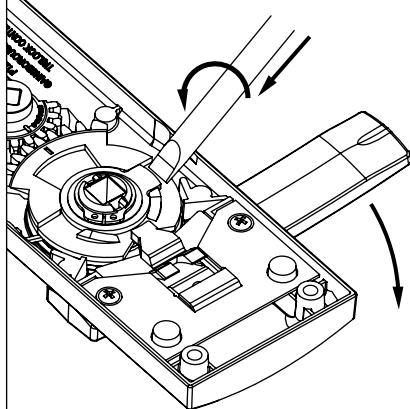

- Hold Trilock furniture plate up to door to check lever orientation (this will need to be done on both levers).
- To re-hand lever, if required, insert flat blade screwdriver under handing-plate and twist to push main gear away from handing plate.
- Rotate lever 180° toward top of faceplate, as shown, until it clicks into place.

NOTE: These steps are applicable to leverset only.

Step 6

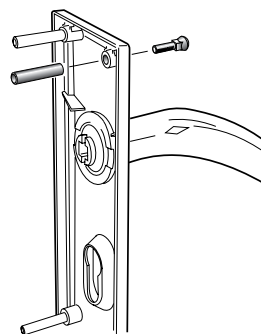

Trilock Traditional

- Install blind screws and brass posts to Trilock external furniture plate (this is the furniture plate **without** the rectangular snib push-button).

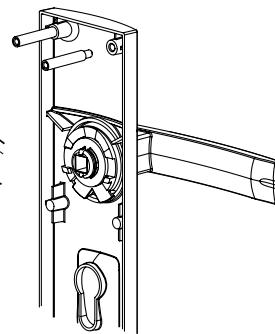

Trilock Contemporary

- Install posts to Trilock external furniture plate (this is the furniture plate **without** the rectangular snib push-button).

Suits 33mm to 45mm door thicknesses

Step 7

- Mount external furniture plate to the outside of door.
- Insert spring, spindle and snib rotor to external furniture plate from inside of door.
- Now mount the internal furniture plate to the inside of door.
- Fit mounting screws from inside & tighten into threaded posts.

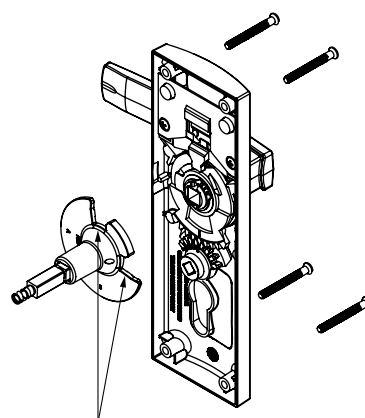
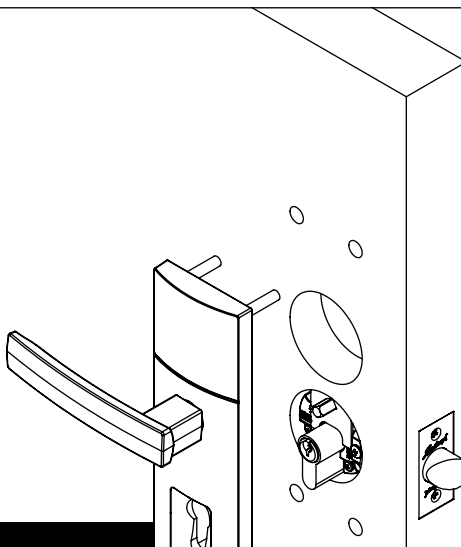

Note: Position Snib Rotor so one notch faces up & the other notch points to the door edge.

NOTE: Test all functions for smooth operation.

Step 8 (single cylinder only)

- For single cylinder applications install internal turnbutton now by tightening grub-screw onto protruding shaft.
- Grub-screw should be fastened up onto flat side of shaft.

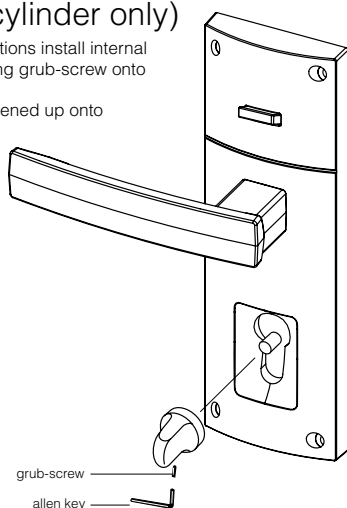

grub-screw
allen key

Step 9

All door seals must be fitted prior to fitting strike plate.

- Position the door so that the centrepoint of the strike plate can be marked on door frame.

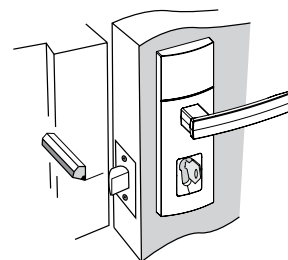
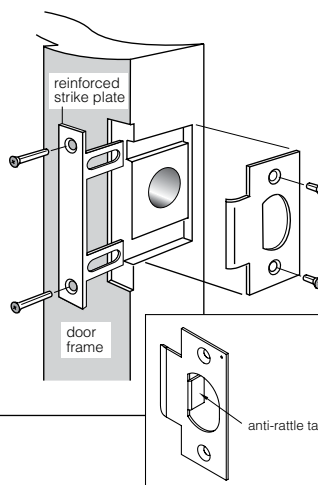

- Mark and drill a 25mm (1") hole to a depth of 25mm (1"), at a corresponding height to the bolt.
- Mark and chisel recesses for strike plate and optional reinforced strike plate.
- Screw into position using 4 wood screws as supplied.

Door Adjustment

- 1 When door is closed using finger pressure, ensure bolt is latching into strike plate.
- 2 If door is rattling when in latched position. Open door, remove strike plate & adjust anti-rattle tab & refit strike plate to door frame. Repeat check 1.

NOTE: • carefully follow these instructions when installing.
• do not overtighten screws.
• use of power driver is not recommended.
• fully remove the Trilock prior to painting the door to avoid harming the product's finish.

Gainsborough
ENTER WITH STYLE™

3 IN 1 FUNCTION
TRILOCK™
DEADBOLT | LOCKSET | PASSAGE SET

Installation Instructions for Trilock Traditional & Contemporary Series – Double & Single Cylinder

These instructions apply to both Lever and Knob versions

Exploded Diagram Double Cylinder

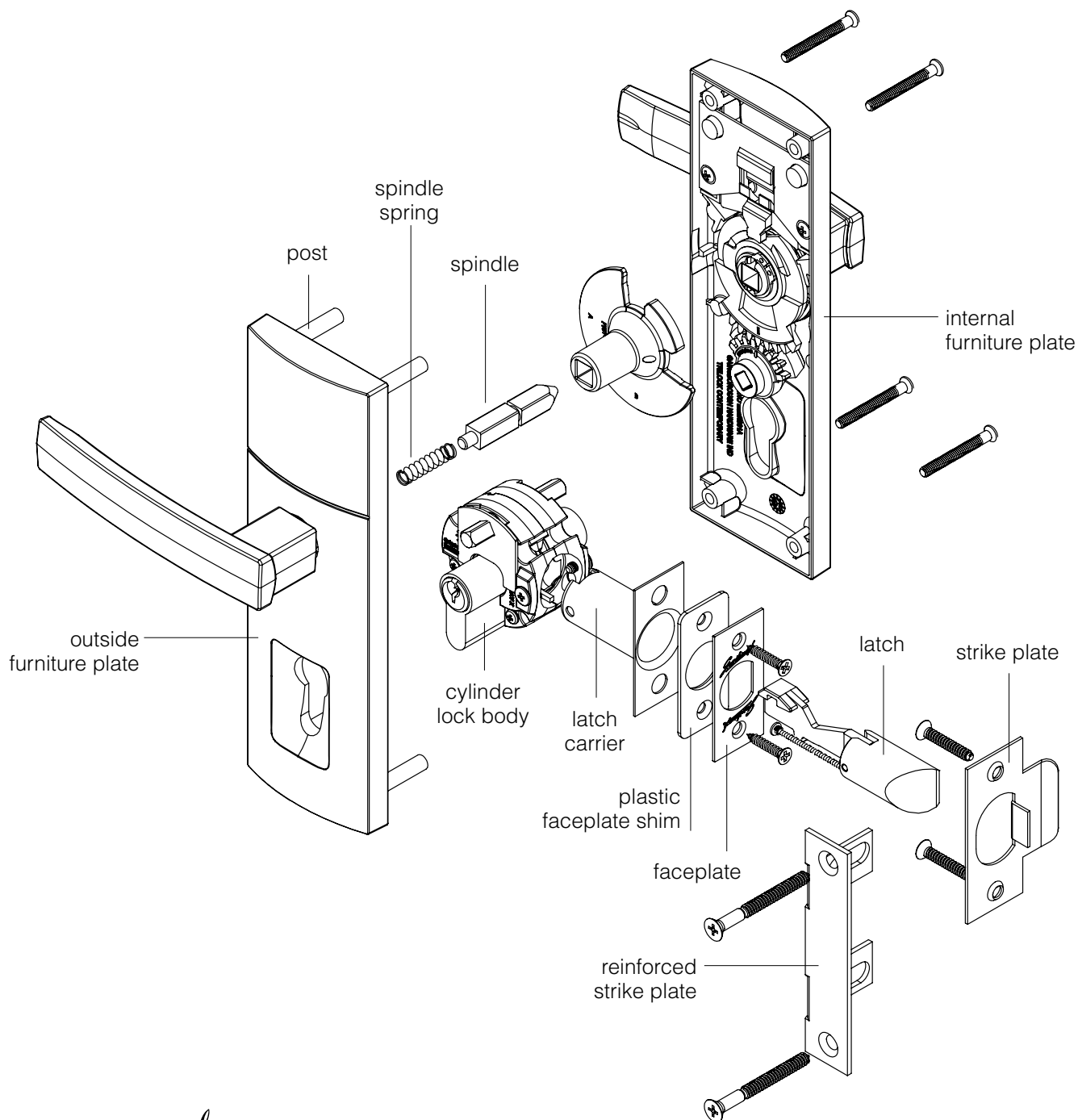

Gainsborough
ENTER WITH STYLE™

3 IN 1 FUNCTION
TRILOCK
DEADBOLT | LOCKSET | PASSAGE SET



Installation Instructions for Trilock Traditional & Contemporary Series – Double & Single Cylinder

These instructions apply to both Lever and Knob versions

Exploded Diagram Single Cylinder

Please note:

For the single cylinder Trilock version, the turnbutton stem should be on the internal side of the door. If this is not the case, please re-hand the lock body.

To re-hand: remove the grub screw with allen key provided, remove and turn the cylinder to desired direction and re-install. Re-fasten grub screw with allen key.

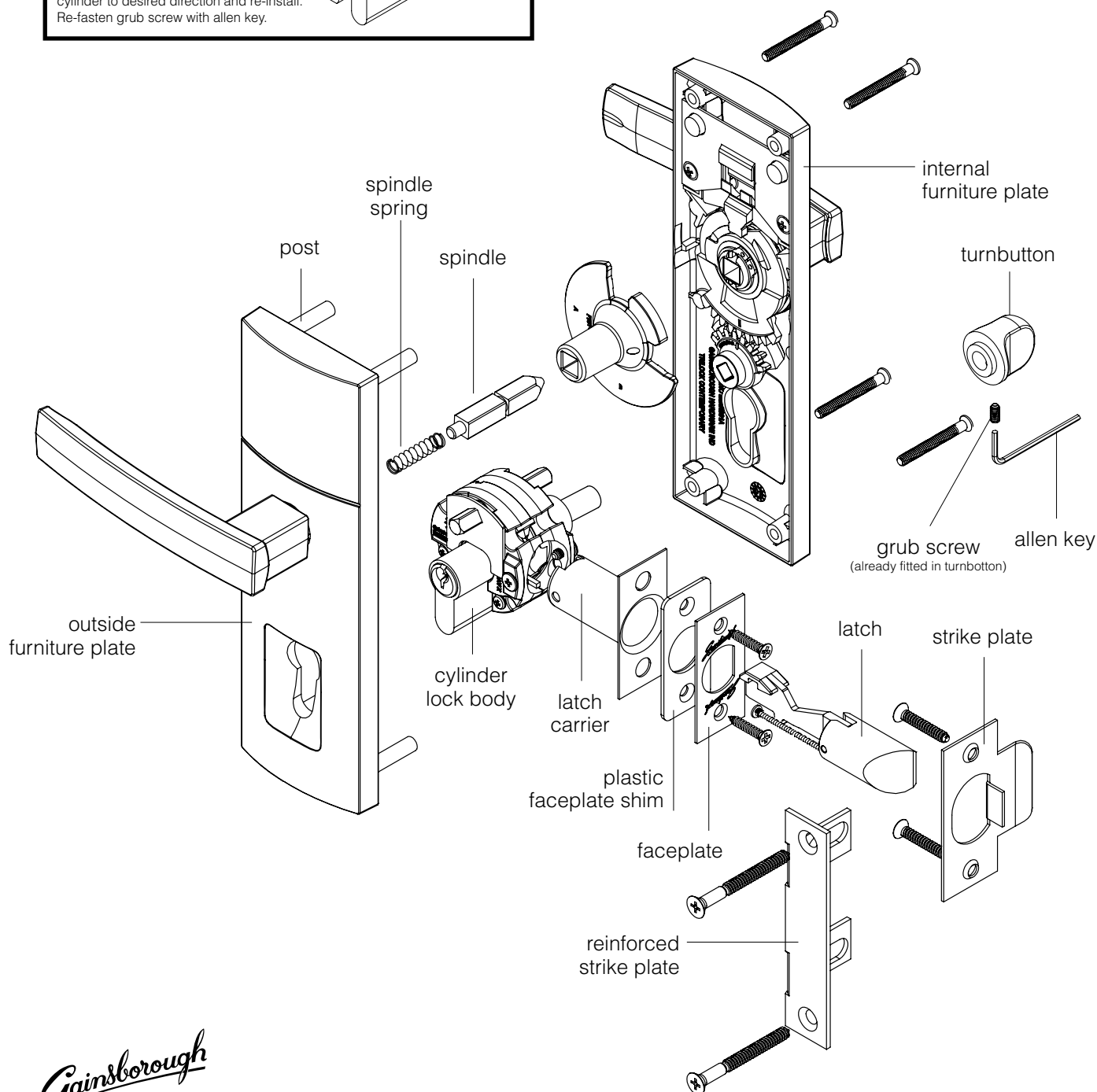
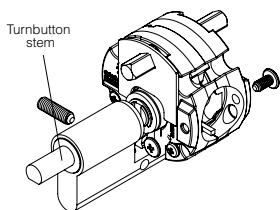

Gainsborough
ENTER WITH STYLE™

3 IN 1 FUNCTION
TRILOCK™
DEADBOLT | LOCKSET | PASSAGE SET



Designed in Australia by Gainsborough Hardware Industries Limited, Melbourne, Australia. A.B.N. 25 004 792 269

www.gainsboroughhardware.com.au