

DEADBOLT LOCKS

Product codes:

9011 | 9012

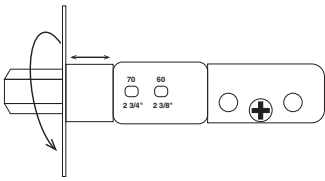

Deadbolt

1. Change the position of the deadbolt to 60mm or 70mm backset by rotating the faceplate.
 - a) Rotate the faceplate clockwise and push to 2-3/8" (60mm) position from 70mm.
 - b) Rotate the faceplate clockwise and pull to 2-3/4" (70mm) position.

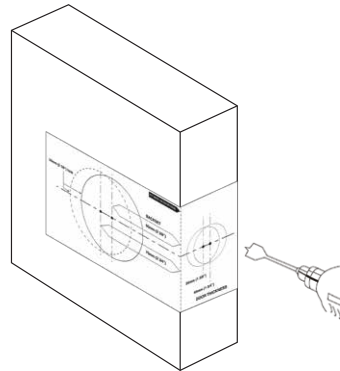

2. Fold the template where indicated on the door edge at the desired deadbolt height. Firmly hold the template in place.
3. Drill a 25mm (1") diameter hole to a depth of 90mm through the door edge choosing the centre point of the correct door thickness. Ensure this hole is square to the door.
4. Drill a 54mm hole through the door face. We recommend using a 54mm hole saw. For clean cut-outs, drill from both sides, meeting in the middle of the door.

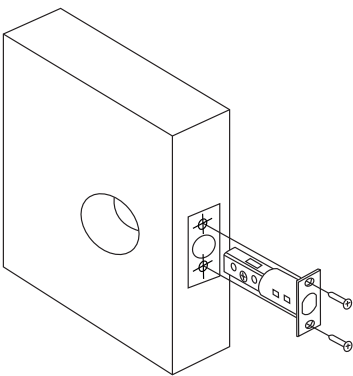

5. Insert the deadbolt, scribe around the faceplate, remove, then chisel out a 4mm recess to enable the faceplate to sit flush with the door edge.
6. Remove any loose saw dust, insert the latch and secure it with the wood screws provided.

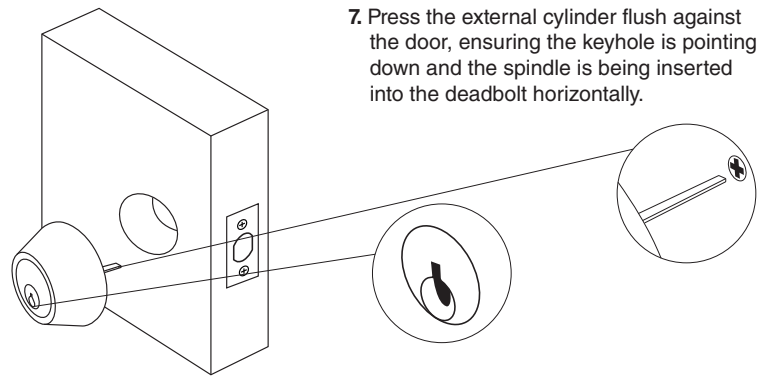
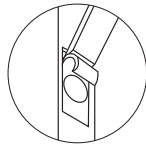

7. Press the external cylinder flush against the door, ensuring the keyhole is pointing down and the spindle is being inserted into the deadbolt horizontally.

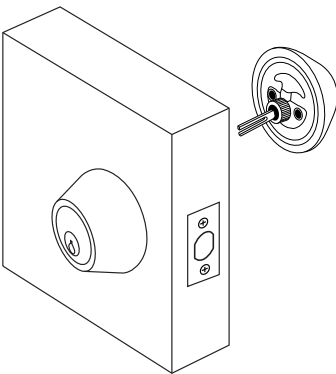

8. Press the internal cylinder/turn flush against the opposite side of the door, ensuring the keyhole/turn is pointing down. For the cylinder ensure the spindle is being inserted through the deadbolt vertically. For the turn the slot for the spindle will be in horizontal position to be able to fit the spindle of the external cylinder. Fasten the cylinder/turn with the screws provided.

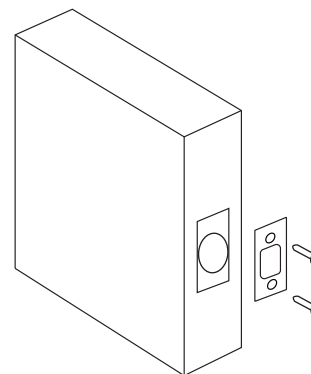
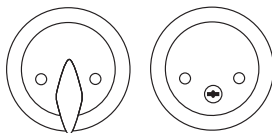

9. Close the door against the door frame with the deadbolt extended and mark the deadbolt position for fitting of the striker.
10. Router or chisel a recess to a depth of 1.5mm so the striker fits flush. Then drill a 25mm hole in the door jamb that aligns with the 25mm hole in the door.
11. Secure the striker with the wood screws provided.

PLEASE PRINT AT 100% SCALE

